

## LED SHOP LIGHT

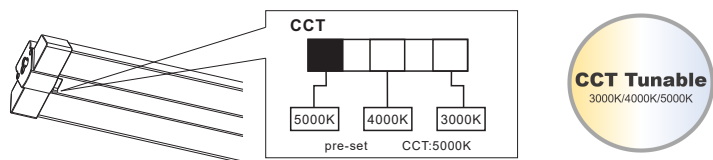

**Application:** residential garage, basement, supermarket, warehouse, office, factory, commercial and industrial space

### FEATURE

- Easy Installation and connection
- Body: Aluminum Heat sink for Efficient Heat Dissipation
- Linkable: with wire harness connection kit included for connecting power between fixtures
- CCT adjustable switch on front of the fixture

### Certifications



### ACCESSORIES

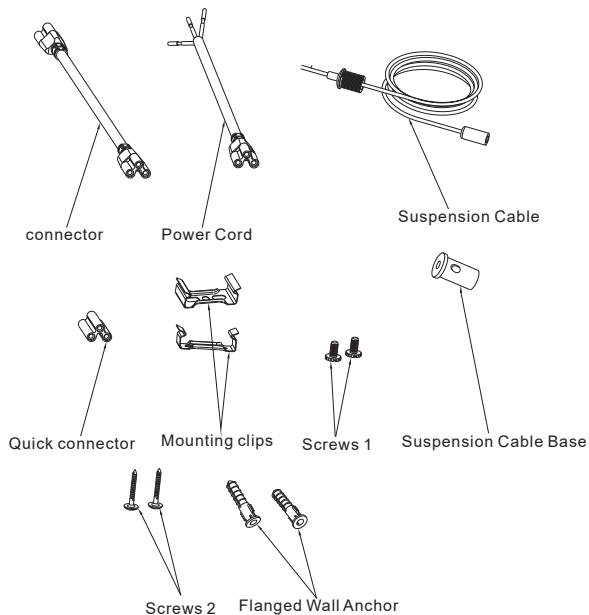

### SPECIFICATIONS

Model No	TCL-4FT-LSP-30W-30K/40K/50K
Power	30W
Input Voltage	AC 110-277V
Luminous Flux	4156.93 LM
Efficacy	130 LM/W
Power Factor	>0.9
CCT	CCT Selectable: 3000K/4000K/5000K
CRI	>80
Working Life	>50,000 hours
Working Temperature	-10°F to 105°F
Protection Level	Dry/Damp Location
DLC Family Code	P50DDZJQ
Qty/Pack	10
Master Package Size	47.83" x 8.66" x 7.87"
Master Package Weight	24.91 LB

## ORDERING CODE DEFINITION

**EXAMPLE: TCL-4FT-LSP-30W-30K/40K/50K**

Company Code	Length	Product	Wattage	CCT
TCL	4FT	LSP: Linear Shop Light	30W	CCT 3000K Tunable 4000K 5000K

## PRODUCT DIMENSIONS

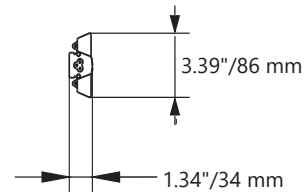
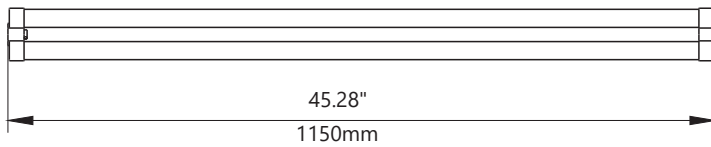

## INSTALLATION INSTRUCTION

### SURFACE MOUNT INSTALLATION

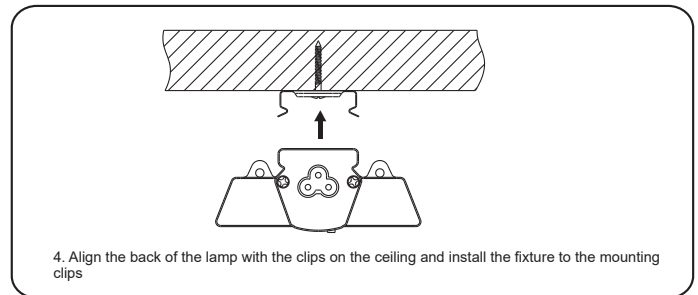
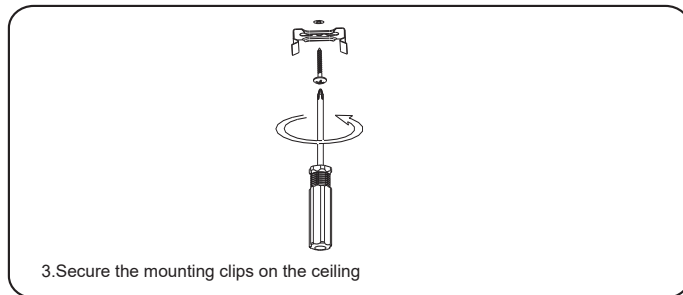
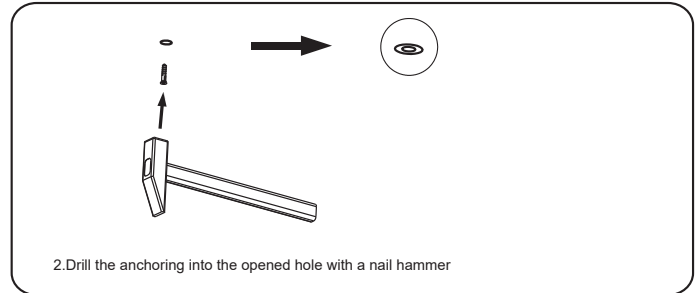
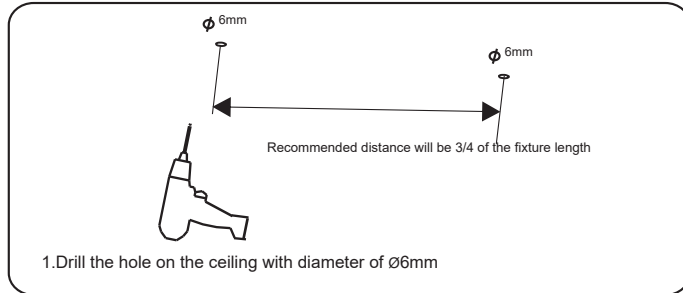

### SUSPENDED MOUNT INSTALLATION

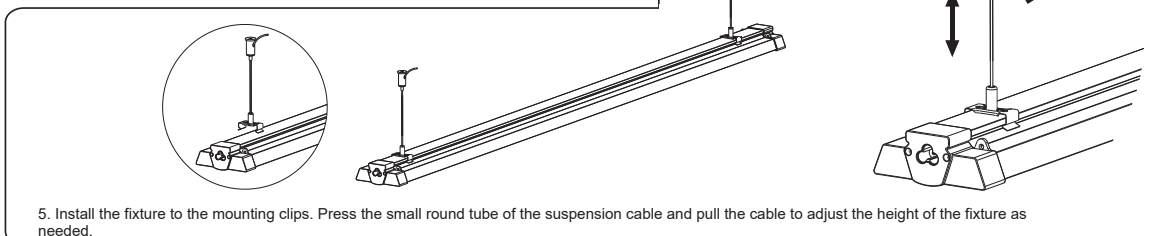
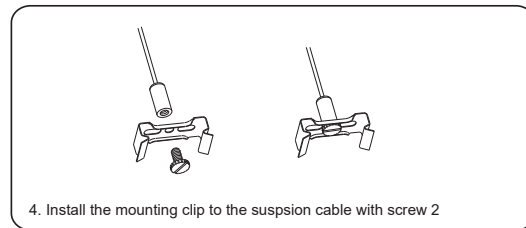
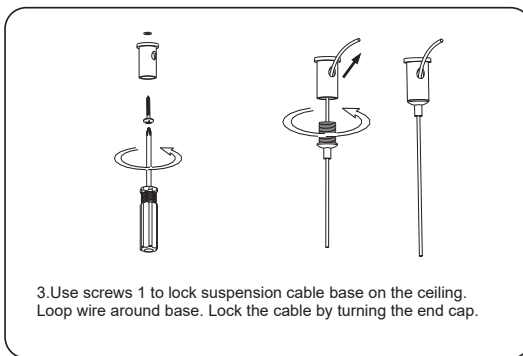
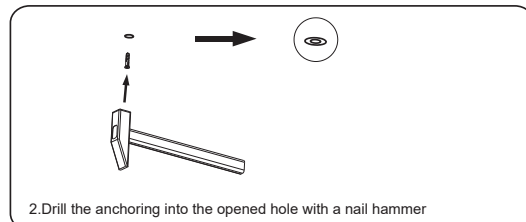
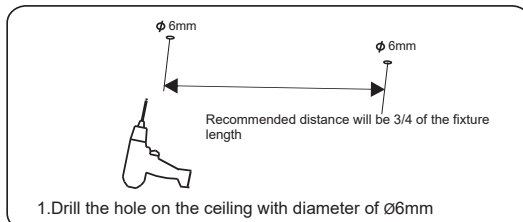

# INSTALLATION INSTRUCTION

## CONNECTION GUIDE

1. Please find the connector in the accessories bag.
2. Plug the connector into the tube.

Note:  
For safety standard,  
please do not connect more than 4pcs 4ft LED lamp in a row; do not  
connect more than 3 pcs 8ft LED lamp in a row.

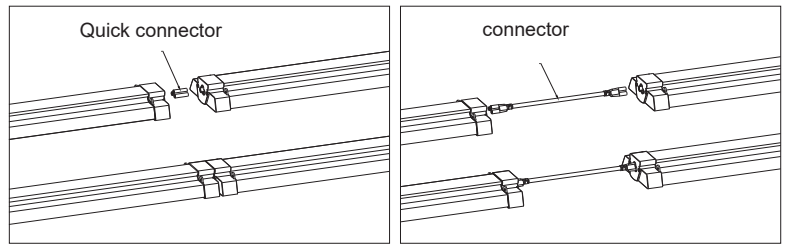

## WIRING

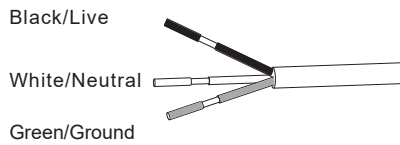

## CCT ADJUSTABLE GUIDE

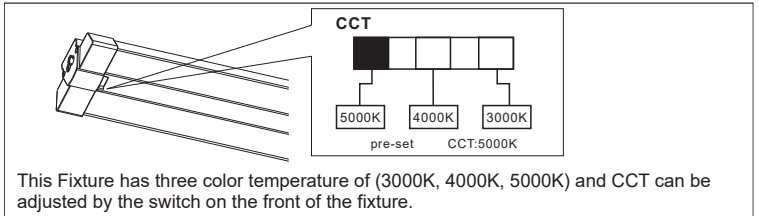

# PHOTOMETRIC REPORT

LUMINOUS INTENSITY DISTRIBUTION DIAGRAM

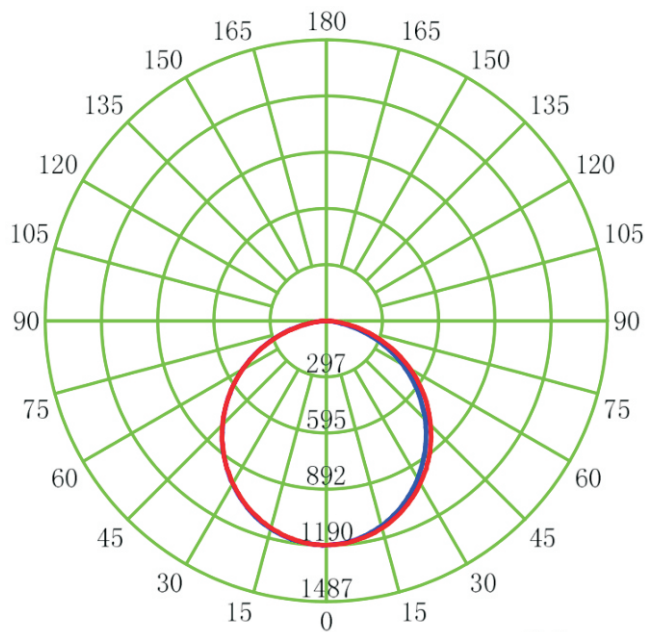

UNIT: cd

— C0-C180      — C90-C270

VERTICAL EQUILUMINOUS CURVE

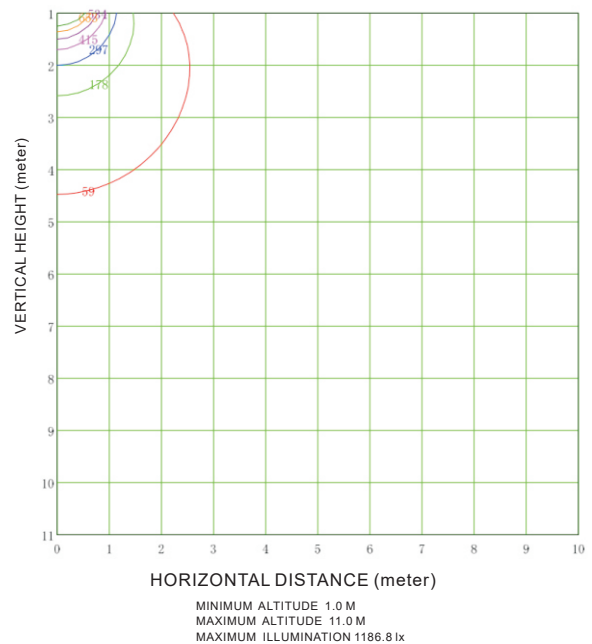

- ( 5% ): 59.3 lx
- ( 15% ): 178.0 lx
- ( 25% ): 296.7 lx
- ( 35% ): 415.4 lx
- ( 45% ): 534.1 lx
- ( 55% ): 652.7 lx
- ( 65% ): 771.4 lx