

# LED 4FT Glass Tube (Type A: Plug and Play)



**Application:** Commercial; Retails; school/institution; government agency; grocery store....



## Specification

Model No.	TCL-T8-F210-15W-A4000K	TCL-T8-F210-15W-A5000K
Power:	15W	
Input Voltage:	AC100-277V	
Luminous Flux:	1950 LM	
Power Factor:	>0.9	
THD:	<10%	
CCT:	4000K	5000K
Cover:	Glass with Frosted Film	
DLC Family ID	P22ZF8XJ	PYRY5K71
CRI:	>80	
Working Life:	>50,000 hours	
Working Temperature:	4°F to 105°F	

## GENERAL DESCRIPTION

The T8 LED TCLbrid Tube is shatter resistant, energy efficient and easy for installation replacement for Fluorescent Tubes. Compatible with existing ballast, this linear tube is thoughtfully designed to be for easy installation.

## FEATURE

- Glass with Outer Film: Prevent the glass break into pieces
- High energy efficiency: save more than 60% energy versus fluorescent lamps
- Ballast compatible: Can be used with existing ballast
- Easy Installation: plug and play
- NOTE: Check the ballast compatibility list before installation

## Installation Guide

1. Disconnect power
2. Remove diffuser (Optional)
3. Removing the existing fluorescent lamp
4. Install the LED Tube Lamp
5. Install diffuser back (if removed in step 2)
6. Turn on power

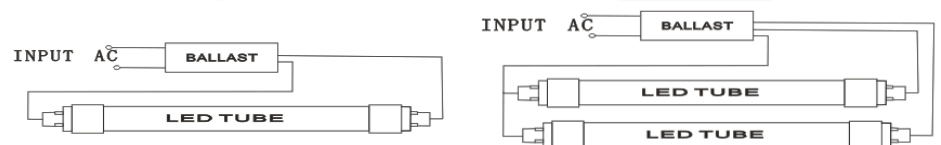
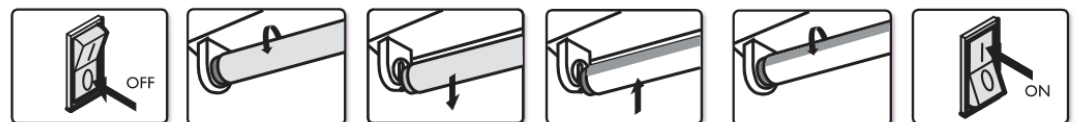

# BALLAST COMPATIBILITY LIST of TYPE A

VERSION : G

UPDATED DATE : 2017/9/01

THE COMPATIBILITY LIST OF BELOW WAS ALL VERIFIED WITH TYPE A

NUMBER	BRAND OF BALLAST	PRODUCT MODEL	OUTPUT	STARTING TYPE
1	ACCUPRO	AP-RC-232IP-120-1	2-LAMP	INSTANT START
2	ACCUPRO	AP-RC-432IP-120	4-LAMP	INSTANT START
3	ESPEN	VE232T8120	2-LAMP	INSTANT START
4	FULHAM CO., INC	WH3-120-L	2-LAMP	INSTANT START
5	FULHAM CO., INC	WH3-120-C	2-LAMP	INSTANT START
6	FULHAM CO., INC	E3 WH3-277-L	3-LAMP	INSTANT START
7	FULHAM CO., INC	WHCG3-120-T8-IS	4-LAMP	INSTANT START
8	FULHAM CO., INC	WHSG3-UNV-T8-IS	3-LAMP	INSTANT START
9	GENERAL ELECTRIC	GE-132-MAX-L/ULTRA	1-LAMP	INSTANT START
10	GENERAL ELECTRIC	GE132-MV-N	1-LAMP	INSTANT START
11	GENERAL ELECTRIC	GE132-MV-PS-L	1-LAMP	INSTANT START
12	GENERAL ELECTRIC	GE132MAXP-L/ULTRA	1-LAMP	INSTANT START
13	GENERAL ELECTRIC	GE132MAXP-N/ULTRA	1-LAMP	INSTANT START
14	GENERAL ELECTRIC	GE132MAX-L/ULTRA	1-LAMP	INSTANT START
15	GENERAL ELECTRIC	GE132MAX-N/ULTRA	1-LAMP	INSTANT START
16	GENERAL ELECTRIC	GE132MAX-H/ULTRA	1-LAMP	INSTANT START
17	GENERAL ELECTRIC	GE132MAX-G-347	1-LAMP	INSTANT START
18	GENERAL ELECTRIC	GE232MV-N-DIY	2-LAMP	INSTANT START
19	GENERAL ELECTRIC	GE232MAX-H/ULTRA	2-LAMP	INSTANT START
20	GENERAL ELECTRIC	GE232MAXP-H/ULTRA	2-LAMP	INSTANT START
21	GENERAL ELECTRIC	GE232-120RES-DIY	2-LAMP	INSTANT START
22	GENERAL ELECTRIC	GE232MAX347-N	2-LAMP	INSTANT START
23	GENERAL ELECTRIC	GE-232-MVPS-H	2-LAMP	PROGRAMMED START
24	GENERAL ELECTRIC	GE-232-MV-PS-L	2-LAMP	PROGRAMMED START
25	GENERAL ELECTRIC	GE232MAX-L/ULTRA	2-LAMP	INSTANT START
26	GENERAL ELECTRIC	GE232 MA	2-LAMP	INSTANT START
27	GENERAL ELECTRIC	GE232MAX-G-N	2-LAMP	INSTANT START
28	GENERAL ELECTRIC	GE232-120-RES	2-LAMP	INSTANT START
29	GENERAL ELECTRIC	GE-232-MV-PS-N	2-LAMP	PROGRAMMED START
30	GENERAL ELECTRIC	GE232-120RESDIYB	2-LAMP	INSTANT START
31	GENERAL ELECTRIC	GE-232-MV-N-42T	2-LAMP	INSTANT START
32	GENERAL ELECTRIC	GE232MAX-G-N-DIYB	2-LAMP	INSTANT START
33	GENERAL ELECTRIC	GE232MAX-N/ULTRA	2-LAMP	INSTANT START
34	GENERAL ELECTRIC	GE259MAX-G-N-DIYB	2-LAMP	INSTANT START
35	GENERAL ELECTRIC	GE259MAX-G-N	2-LAMP	INSTANT START
36	GENERAL ELECTRIC	GE332MV-N-DIY	3-LAMP	INSTANT START
37	GENERAL ELECTRIC	GE332MAX-L/ULTRA	3-LAMP	INSTANT START
38	GENERAL ELECTRIC	GE332MAX-G-N	3-LAMP	INSTANT START

# BALLAST COMPATIBILITY LIST of TYPE A

VERSION : G

UPDATED DATE : 2017/9/01

**THE COMPATIBILITY LIST OF BELOW WAS ALL VERIFIED WITH TYPE A**

NUMBER	BRAND OF BALLAST	PRODUCT MODEL	OUTPUT	STARTING TYPE
39	GENERAL ELECTRIC	GE332MAX-G-N-DZYB	3-LAMP	INSTANT START
40	GENERAL ELECTRIC	GE332MAX-L	3-LAMP	INSTANT START
41	GENERAL ELECTRIC	GE332MAX-G-H	3-LAMP	INSTANT START
42	GENERAL ELECTRIC	GE332MV-L	3-LAMP	INSTANT START
43	GENERAL ELECTRIC	GE332MAX-N/ULTRA	3-LAMP	INSTANT START
44	GENERAL ELECTRIC	GE332MAX-G-N-DIYB	3-LAMP	INSTANT START
45	GENERAL ELECTRIC	GE432MAX-G-N	3-LAMP	INSTANT START
46	GENERAL ELECTRIC	GE332MAX-G-L	3-LAMP	INSTANT START
47	GENERAL ELECTRIC	GE332MAXP-N/ULTRA	3-LAMP	INSTANT START
48	GENERAL ELECTRIC	GE-432-MAX-L-ULTRA	4-LAMP	INSTANT START
49	GENERAL ELECTRIC	GE432MAX347-N	4-LAMP	INSTANT START
50	GENERAL ELECTRIC	GE432MVPS-H-42T	4-LAMP	PROGRAMMED START
51	GENERAL ELECTRIC	GE432-MVPS-N	4-LAMP	INSTANT START
52	GENERAL ELECTRIC	GE432MAX-H/ULTRA	4-LAMP	INSTANT START
53	GENERAL ELECTRIC	GE432MAX-H-42T	4-LAMP	INSTANT START
54	GENERAL ELECTRIC	GE432-MV-N-42T	4-LAMP	INSTANT START
55	GENERAL ELECTRIC	GE-432-MV-N-42F	4-LAMP	INSTANT START
56	GENERAL ELECTRIC	GE432MV-N-DIY	4-LAMP	INSTANT START
57	GENERAL ELECTRIC	GE432MAXP-H	4-LAMP	INSTANT START
58	GENERAL ELECTRIC	GE432MAXP-N/ULTRA	4-LAMP	INSTANT START
59	GENERAL ELECTRIC	GE432-120RES-DIY	4-LAMP	INSTANT START
60	GENERAL ELECTRIC	GE432-120RES-DIYB	4-LAMP	INSTANT START
61	GENERAL ELECTRIC	GE432MAX-N/ULTRA	4-LAMP	INSTANT START
62	GENERAL ELECTRIC	GE432MAXP90-S60	4-LAMP	INSTANT START
63	GENERAL ELECTRIC	GE432MAX-G-L	4-LAMP	INSTANT START
64	HALCO	EP132IS/MV/MC	1-LAMP	INSTANT START
65	HALCO	EP332IS/H/MV/SL	3-LAMP	INSTANT START
66	HALCO	EP432IS/L/MV/HE	4-LAMP	INSTANT START
67	HALCO	EP432IS/MV/HE	4-LAMP	INSTANT START
68	HOWARD	EPH3/32IS-MV/MC/HE	3-LAMP	INSTANT START
69	HOWARD	EP4/32IS-MV/MC/HE	4-LAMP	INSTANT START
70	HOWARD INDUSTRIES	EP2/32IS/MV/MC/HE	2-LAMP	INSTANT START
71	HOWARD INDUSTRIES	EP3/32IS/MV/MC/HE	3-LAMP	INSTANT START
72	HOWARD INDUSTRIES	EPH4/32IS/MV/SC/HE	4-LAMP	INSTANT START
73	HOWARD INDUSTRIES	EP4/32IS/MV/MC/HE	4-LAMP	INSTANT START
74	KEYSTONE	KTEB-232RIS-1-TP-SL	2-LAMP	INSTANT START
75	KEYSTONE	KTEB-232-UV-IS-N-P	2-LAMP	INSTANT START
76	KEYSTONE	KTEB-332-UV-IS-H-P	4-LAMP	INSTANT START

# BALLAST COMPATIBILITY LIST of TYPE A

VERSION : G

UPDATED DATE : 2017/9/01

**THE COMPATIBILITY LIST OF BELOW WAS ALL VERIFIED WITH TYPE A**

NUMBER	BRAND OF BALLAST	PRODUCT MODEL	OUTPUT	STARTING TYPE
77	KEYSTONE	KTEB-432-UV-IS-N-P	4-LAMP	INSTANT START
78	OSRAM /SYLVANIA	QTP 1X32T8/UNV ISU-SC	1-LAMP	INSTANT START
79	OSRAM /SYLVANIA	QHE 1X32T8/UNV ISH HT SC	1-LAMP	INSTANT START
80	OSRAM /SYLVANIA	QHE 1X32T8/UNV ISL-SC	1-LAMP	INSTANT START
81	OSRAM /SYLVANIA	QHE 1X32T8/UNV ISH-SC	1-LAMP	INSTANT START
82	OSRAM /SYLVANIA	QHE 1X32T8/UNV PSN-MC	1-LAMP	PROGRAMMED START
83	OSRAM /SYLVANIA	QHE 2X32T8/UNV ISH HT-SC	2-LAMP	INSTANT START
84	OSRAM /SYLVANIA	QHE 2X32T8/UNV DIM-TC	2-LAMP	PROGRAMMED START
85	OSRAM /SYLVANIA	QHE 3X32T8/UNV ISN-SC	3-LAMP	INSTANT START
86	OSRAM /SYLVANIA	QHE 3X32T8/UNV PSN-SC	3-LAMP	PROGRAMMED START
87	OSRAM /SYLVANIA	QHE 4X32T8/UNV PSN-SC	4-LAMP	PROGRAMMED START
88	OSRAM /SYLVANIA	QHE 4X32T8/UNV ISH	4-LAMP	INSTANT START
89	OSRAM /SYLVANIA	QHE 4X32T8/347 ISN-SC	4-LAMP	INSTANT START
90	OSRAM SYLVANIA	QHE 1X32T8/347 ISN-SC	1-LAMP	INSTANT START
91	OSRAM SYLVANIA	QHE 1X32T8/UNV ISN-SC	1-LAMP	INSTANT START
92	OSRAM SYLVANIA	QTP 1X32T8/UNV ISL-SC	1-LAMP	INSTANT START
93	OSRAM SYLVANIA	QT2X32T8/347 ISH-SC	2-LAMP	INSTANT START
94	OSRAM SYLVANIA	QTP 2X32T8/UNV ISN-SC	2-LAMP	INSTANT START
95	OSRAM SYLVANIA	QHE 2X32T8/UNV ISN-SC	2-LAMP	INSTANT START
96	OSRAM SYLVANIA	QHE 2X32T8/UNV ISH-SC	2-LAMP	INSTANT START
97	OSRAM SYLVANIA	QHE 2X32T8/UNV PSN-MC	2-LAMP	PROGRAMMED START
98	OSRAM SYLVANIA	QHE 3X32T8/UNV ISL-SC	3-LAMP	INSTANT START
99	OSRAM SYLVANIA	QHE 3X32T8/UNV ISH-SC	3-LAMP	INSTANT START
100	OSRAM SYLVANIA	QTP 3X32T8/UNV ISH-SC	3-LAMP	INSTANT START
101	OSRAM SYLVANIA	QHE 3X32T8/UNV PSH-HT-SC	3-LAMP	PROGRAMMED START
102	OSRAM SYLVANIA	QTP 3X32T8/UNV ISN-SC	3-LAMP	INSTANT START
103	OSRAM SYLVANIA	QT4X32T8/347 ISN-SC	4-LAMP	INSTANT START
104	OSRAM SYLVANIA	QTP 4X32T8/UNV ISN-SC	4-LAMP	INSTANT START
105	OSRAM SYLVANIA	QHE 4X32T8/UNV ISL-SC	4-LAMP	INSTANT START
106	OSRAM SYLVANIA	QHE 4X32T8/UNV PSH-HT	4-LAMP	PROGRAMMED START
107	OSRAM SYLVANIA	QHE 4X32T8/UNV ISH-SC	4-LAMP	INSTANT START
108	OSRAM SYLVANIA	QHE 4X32T8/UNV ISN-SC	4-LAMP	INSTANT START
109	PHILIPS ADVANCE	ICN-1P32-N	1-LAMP	INSTANT START
110	PHILIPS ADVANCE	IOPA-1P32-N	1-LAMP	INSTANT START
111	PHILIPS ADVANCE	REB-2P32-SC	2-LAMP	INSTANT START
112	PHILIPS ADVANCE	REL-2P32-SC	2-LAMP	INSTANT START
113	PHILIPS ADVANCE	ICN-2P32-N	2-LAMP	INSTANT START
114	PHILIPS ADVANCE	GOPA-2P32-SC	2-LAMP	INSTANT START

# BALLAST COMPATIBILITY LIST of TYPE A

VERSION : G

UPDATED DATE : 2017/9/01

**THE COMPATIBILITY LIST OF BELOW WAS ALL VERIFIED WITH TYPE A**

NUMBER	BRAND OF BALLAST	PRODUCT MODEL	OUTPUT	STARTING TYPE
115	PHILIPS ADVANCE	IOP-2PSP32-SC	2-LAMP	PROGRAMMED START
116	PHILIPS ADVANCE	ICN-2S40-N	2-LAMP	PROGRAMMED START
117	PHILIPS ADVANCE	IOP-2P32HL-SC	2-LAMP	INSTANT START
118	PHILIPS ADVANCE	IOPA-2P32HL-N	2-LAMP	INSTANT START
119	PHILIPS ADVANCE	IOPA-2P32HL-SC	2-LAMP	INSTANT START
120	PHILIPS ADVANCE	IOPA-2P32-N	2-LAMP	INSTANT START
121	PHILIPS ADVANCE	IDA-2S32-SC	2-LAMP	PROGRAMMED START
122	PHILIPS ADVANCE	VEL-2P32-SC	2-LAMP	INSTANT START
123	PHILIPS ADVANCE	IOPA-2P32-LW-N	2-LAMP	INSTANT START
124	PHILIPS ADVANCE	IOP-2P32-N	2-LAMP	INSTANT START
125	PHILIPS ADVANCE	ICN-3P32-N	3-LAMP	INSTANT START
126	PHILIPS ADVANCE	IOP-3PSP32-SC	3-LAMP	PROGRAMMED START
127	PHILIPS ADVANCE	IOP-3PSP32-LW-SC	3-LAMP	PROGRAMMED START
128	PHILIPS ADVANCE	IOPA-3P32-N	3-LAMP	INSTANT START
129	PHILIPS ADVANCE	IOP-3P32-N	3-LAMP	INSTANT START
130	PHILIPS ADVANCE	IOPA-3P32HL-SC	3-LAMP	INSTANT START
131	PHILIPS ADVANCE	ICN-4P32-SC	4-LAMP	INSTANT START
132	PHILIPS ADVANCE	ICN-4P32-N	4-LAMP	INSTANT START
133	PHILIPS ADVANCE	REB-4P32-SC	4-LAMP	INSTANT START
134	PHILIPS ADVANCE	IOPA-4P32-LW-N	4-LAMP	INSTANT START
135	PHILIPS ADVANCE	IOPA-4P32-SC	4-LAMP	INSTANT START
136	PHILIPS ADVANCE	GOPA-4P32-SC	4-LAMP	INSTANT START
137	PHILIPS ADVANCE	VEL-4P32-SC	4-LAMP	INSTANT START
138	PHILIPS ADVANCE	IOP-4P32-LW-N	4-LAMP	INSTANT START
139	PHILIPS ADVANCE	IOPA-4P32-N	4-LAMP	INSTANT START
140	PHILIPS ADVANCE	IOP-4P32-N	4-LAMP	INSTANT START
141	ROBERTSON	ISU232T8120	2-LAMP	INSTANT START
142	ROBERTSON	ISA259T8MV	3-LAMP	INSTANT START
143	ROBERTSON	ISL432T8HEMV	4-LAMP	INSTANT START
144	STANDARD	E232T8IS120-277/N/AS	2-LAMP	INSTANT START
145	STANDARD	E232T8IS10/N/AS/BULK	2-LAMP	INSTANT START
146	STANDARD	E432T8IS10/N/AS/BULK	4-LAMP	INSTANT START
147	SUNPARK	U-2/32ISE	2-LAMP	INSTANT START
148	SUNPARK	120-2/32IS MPF	2-LAMP	INSTANT START
149	SUNPARK	U-3/32ISE	3-LAMP	INSTANT START
150	SUNPARK	U-3/32ISE-LBF	3-LAMP	INSTANT START
151	SUNPARK	U-4/32ISE-HBF	4-LAMP	INSTANT START
152	SUNPARK	120-4/32IS MPF	4-LAMP	INSTANT START
153	ULTRASAVE	UT 232347	2-LAMP	INSTANT START
154	UNIVERSAL	B132IUNVEL-A	1-LAMP	INSTANT START

# BALLAST COMPATIBILITY LIST of TYPE A

VERSION : G

UPDATED DATE : 2017/9/01

THE COMPATIBILITY LIST OF BELOW WAS ALL VERIFIED WITH TYPE A

NUMBER	BRAND OF BALLAST	PRODUCT MODEL	OUTPUT	STARTING TYPE
155	UNIVERSAL	B132IUNVHP-N	1-LAMP	INSTANT START
156	UNIVERSAL	B132IUNVHP-B	1-LAMP	INSTANT START
157	UNIVERSAL	B232IUNVHE-A	2-LAMP	INSTANT START
158	UNIVERSAL	B232PUNVHE-B	2-LAMP	PROGRAMMED START
159	UNIVERSAL	B232IUNVHP-B	2-LAMP	INSTANT START
160	UNIVERSAL	B232IUNVHP-N	2-LAMP	INSTANT START
161	UNIVERSAL	B232IUNVHEH-A	2-LAMP	INSTANT START
162	UNIVERSAL	ET232120M	2-LAMP	INSTANT START
163	UNIVERSAL	B259IUNVHP-A	2-LAMP	INSTANT START
164	UNIVERSAL	B232I347HP-A	2-LAMP	INSTANT START
165	UNIVERSAL	B232IUNVEL-A	3-LAMP	INSTANT START
166	UNIVERSAL	B332IUNVHE-A	3-LAMP	INSTANT START
167	UNIVERSAL	B232IUNVHP-A	3-LAMP	INSTANT START
168	UNIVERSAL	B332IUNVHP-A	3-LAMP	INSTANT START
169	UNIVERSAL	B432IUNVHE-A	4-LAMP	INSTANT START
170	UNIVERSAL	B432IUNVEL-A	4-LAMP	INSTANT START
171	UNIVERSAL	B432I347HP	4-LAMP	INSTANT START
172	UNIVERSAL	B432I347HPL	4-LAMP	INSTANT START
173	UNIVERSAL	B432IUNVHP-A	4-LAMP	INSTANT START

\*Updated 14 new compatible models marked in red wording

Note:

- 1. The ballasts model list on the chart have been test and already get approved by manufacturer;**
- 2. Absence of a ballast from this chart does not imply incompatibility. Please reference the ballast manufacturer's instructions for installation and further information.**
- 3. This list is to be used as a general guideline, the LED tube may not work if the ballast is over 5 years old or have a weak starting voltage.**
- 4. Please strictly follow the wiring diagram shown on the ballasts;**
- 5. Please check if the contact points of the old fixture work normal**
- 6. Please use caution and test lamps in fixtures for an extended period of time to ensure proper operation ;**
- 7. Do not proceed with a mass installation until proper operation of the LED tube is verified.**
- 8. We will continuously testing new model ballasts in lab, pls contact manufacturer to get latest compatibility list;**