

LED T8 INTEGRATED TUBE

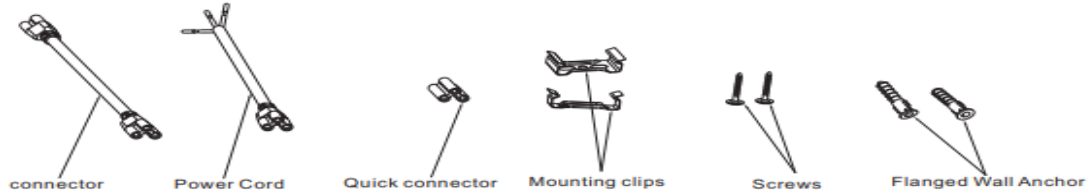

Application: Retail; Signes, Awning, Residential garage; school/institution; government agency; grocery store and more...

ACCESSORIES



FEATURE

- Working temperature: - 4°F ~+104°F / -20°C ~+40°C
- Suitable for damp location
- Body: Aluminum Heatsink for Efficient Heat Dissipation
- Linkable: quick connector for east installation
- Lumen Maintenance over 70% @ 50,000+ Hours
- Beam Angle: 110°
- Max Connected Load: 3 Amps

ORDERING GUIDE

Model	Length	Watt	CCT	Cover	Lumens	Current @ 120V	Current @277V	MAX Connection PCS	PF	CRI	Voltage
TCL-T8INT-2FT-10W-65K(T)	2ft	10W	6500K	Clear	1300 lm	95mA	40mA	16	>0.9	>80	120-277V
TCL-T8INT-2FT-10W-50K(F)	2ft	64W	5000K	Frosted	1300 lm	95mA	40mA	16	>0.9	>80	120-277V
TCL-T8INT-3FT-18W-50K(F)	3ft	18W	5000K	Frosted	2340 lm	160mA	72mA	12	>0.9	>80	120-277V
TCL-T8INT-3FT-18W-65K(T)	3ft	18W	6500K	Clear	2340 lm	160mA	72mA	12	>0.9	>80	120-277V
TCL-T8INT-4FT-24W-65K(T)	4ft	24W	6500K	Clear	3120 lm	230mA	100mA	8	>0.9	>80	120-277V
TCL-T8INT-4FT-24W-50K(F)	4ft	24W	5000K	Frosted	3120 lm	230mA	100mA	8	>0.9	>80	120-277V
TCL-T8INT-4FT-24W-50K(T)	4ft	24W	5000K	Clear	3120 lm	230mA	100mA	8	>0.9	>80	120-277V
TCL-T8INT-5FT-36W-50K(F)	5ft	36W	5000K	Frosted	4680 lm	330mA	150mA	6	>0.9	>80	120-277V
TCL-T8INT-5FT-36W-65K(T)	5ft	36W	6500K	Clear	4680 lm	330mA	150mA	6	>0.9	>80	120-277V
TCL-T8INT-6FT-48W-50K(F)	6ft	48W	5000K	Frosted	6240 lm	450mA	200mA	5	>0.9	>80	120-277V
TCL-T8INT-6FT-48W-65K(T)	6ft	48W	6500K	Clear	6240 lm	450mA	200mA	5	>0.9	>80	120-277V
TCL-T8INT-8FT-60W-35K(F)	8ft	60W	3500K	Frosted	7800 lm	560mA	250mA	4	>0.9	>80	120-277V
TCL-T8INT-8FT-60W-50K(F)	8ft	60W	5000K	Frosted	7800 lm	560mA	250mA	4	>0.9	>80	120-277V
TCL-T8INT-8FT-60W-50K(T)	8ft	60W	5000K	Clear	7800 lm	560mA	250mA	4	>0.9	>80	120-277V

LED T8 INTEGRATED TUBE

DIMENSION

Front View

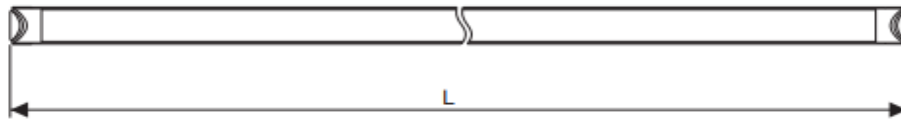

Side View

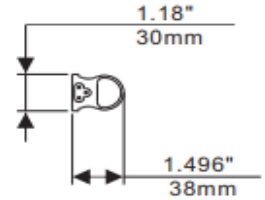

Length Dimension

Size:	2ft	3ft	4ft	5ft	6ft	8ft
Length Dimension:	593mm\23.35"	893mm\35.16"	1196mm\47.09"	1493mm\58.78"	1763mm\69.41"	2368mm\93.23"

PACKAGE INFO

Size:	2ft	3ft	4ft	5ft	6ft	8ft
Qty/Pack	20 PCS/PACK					
Package Size	645X210X170mm 25.4"X8.27"X6.69"	945X210X170mm 25.4"X8.27"X6.69"	1270X210X170mm 50"X8.27"X6.69"	1545X210X170mm 60.83"X8.27"X6.69"	1825X210X170mm 71.85"X8.27"X6.69"	2425X210X170mm 95.47"X8.27"X6.69"
Package Weight	5 kg/11.02 lbs	6.8 kg/14.99 lbs	8.2kg/18.08 lbs	10.7 kg/23.59 lbs	12 kg/26.46 lbs	14.9 kg/32.85 lbs
Package CBM	0.023027	0.033737	0.045339	0.055157	0.065153	0.086573
40GP Capacity	~50370 PCS	~34380 PCS	~25580 PCS	~21030 PCS	~17800 PCS	~13390 PCS
40HQ Capacity	~59060 PCS	~40310 PCS	~29990 PCS	~24650 PCS	~20870 PCS	~15700 PCS
45HQ Capacity	~67740 PCS	~46240 PCS	~34400 PCS	~28280 PCS	~23940 PCS	~18010 PCS

PHOTOMETRIC REPORT

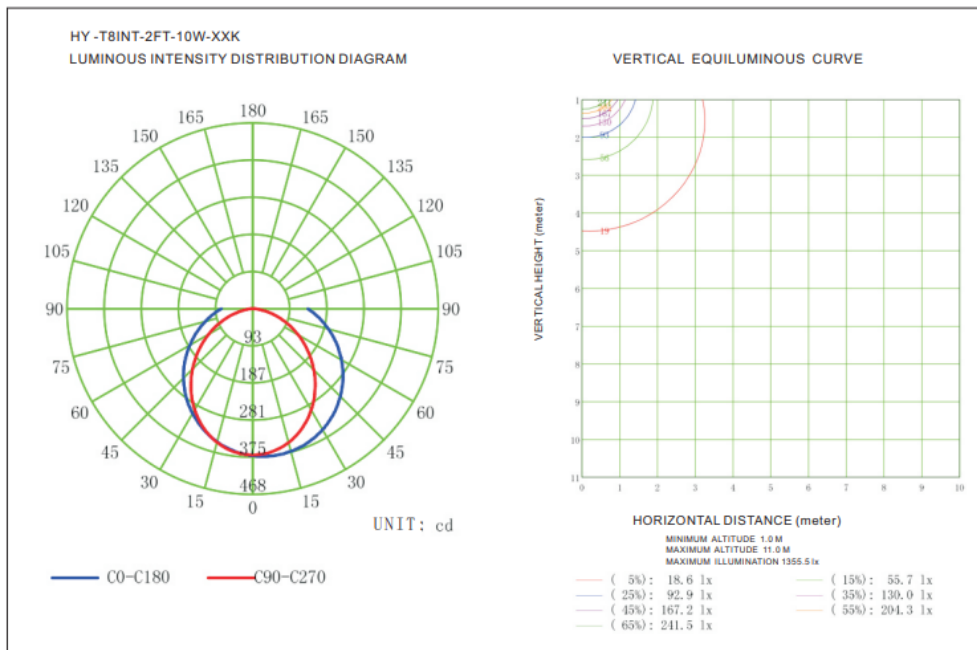

LED T8 INTEGRATED TUBE

INSTALLATION

Surface Mount Installation

Surface mount installation

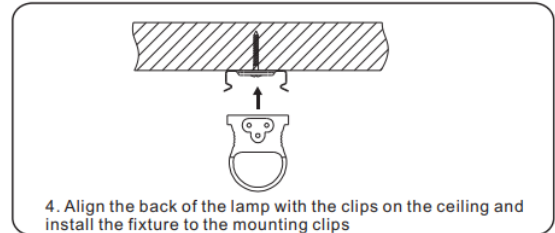
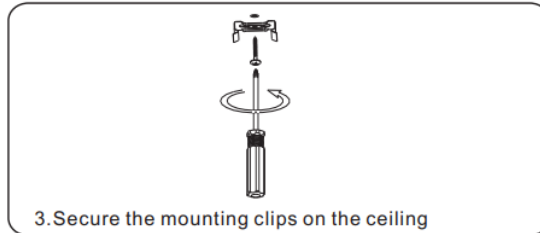
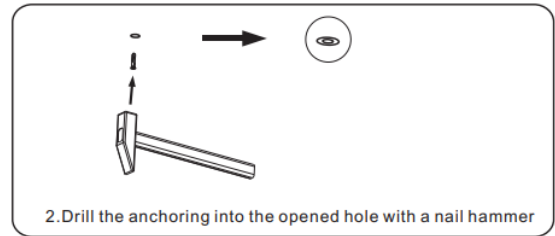
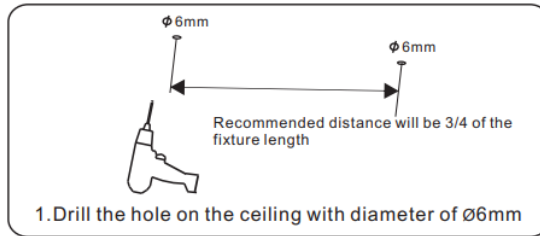

Suspension Installation

Wiring Guide

Black/Live

White/Neutral

Green/Earth

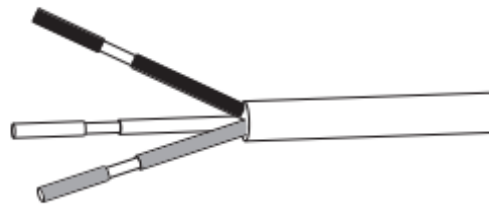

Connection Installation

Connection Installation

1. Please find the connector in the accessories bag.
2. Plug the connector into the tube.

Note:
 For safety standard, it is recommended that:
 please do not connect more than 5pcs 2ft,3ft LED lamp in a row;
 do not connect more than 4 pcs 4ft LED lamp in a row;
 do not connect more than 3 pcs 5ft,6ft,8ft LED lamp in a row;

