

## LED T8 INTEGRATED TUBE -T8 INT V Shape

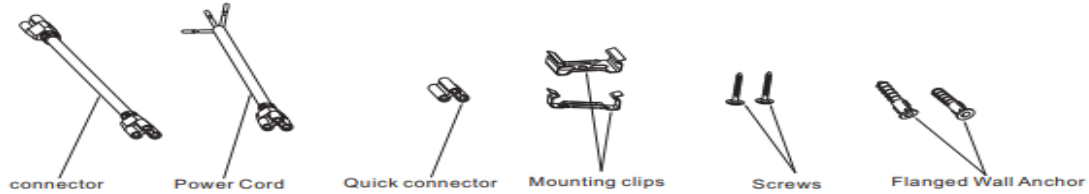

**Application:** Retails; Signes, Awning, Residential garage; school/institution; government agency; grocery store and more...

### Accessories



### FEATURE

- Working temperature: - 4°F ~+104°F / -20°C ~+40°C
- Suitable for damp location
- Body: Aluminum Heatsink for Efficient Heat Dissipation
- Diffusers are extruded from impact modified acrylic for increased durability
- Linkable: quick connector for east installation
- Lumen Maintenance over 70% @ 50,000+ Hours
- CRI: 80+; PF>0.9
- Max Connected Load: 3 Amps (No more than 4 pcs for 4FT and 3 pcs for 8FT)

### ORDERING GUIDE

Model	Length	Watt	CCT	Cover	Current	Beam Angle	Lumens	Voltage
TCL-T8INT-4FT-36W-65K(V)	4ft	36W	6500K	Clear	330mA@120V; 150mA@277V	270°	4680 lm	120-277V
TCL-T8INT-8FT-60W-65K(V)	8ft	60W	5000K	Clear	560mA@120V; 250mA@277V	270°	7800 lm	120-277V

### DIMENSION

Front View

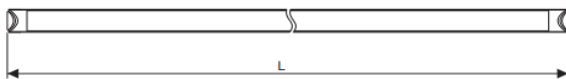

Side View

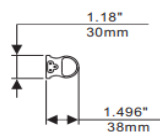

#### Length Dimension

Size:	4ft	8ft
Length Dimension:	1196mm\47.09"	2368mm\93.23"

#### Package Info

Qty/Pack	20 PCS/PACK	
Package Size	1270X210X170mm 50"X8.27"X6.69"	2425X210X170mm 95.47"X8.27"X6.69"
Package Weight	8.2kg/18.08 lbs	14.9 kg/32.85 lbs
Package CBM	0.045339	0.086573
40GP Capacity	~25580 PCS	~13390 PCS
40HQ Capacity	~29990 PCS	~15700 PCS
45HQ Capacity	~34400 PCS	~18010 PCS

## LED T8 INTEGRATED TUBE - T8 INT V Shape

### INSTALLATION

#### Surface Mount Installation

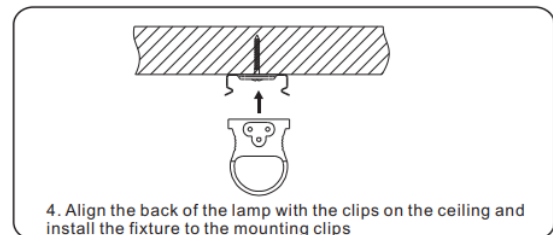
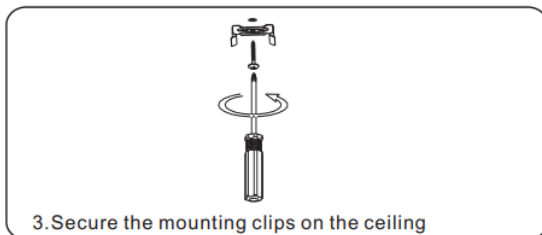
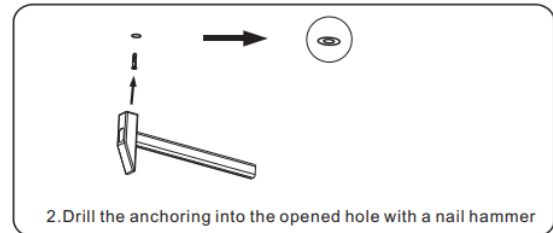
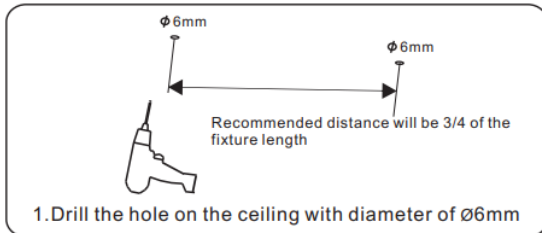

#### Wiring Guide

Black/Live

White/Neutral

Green/Earth

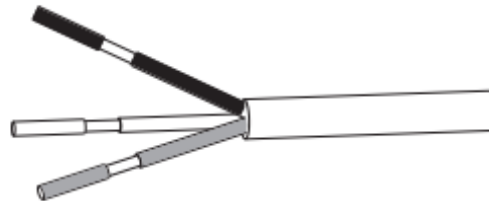

#### Connection Installation

1. Please find the connector in the accessories bag.
2. Plug the connector into the tube.

Note:  
 For safety standard,  
 please do not connect more than 5pcs 2ft,3ft LED lamp in a row;  
 do not connect more than 4 pcs 4ft LED lamp in a row;  
 do not connect more than 3 pcs 5ft,6ft,8ft LED lamp in a row;

