

## LED TRI-PROOF LIGHT - LV401 Series

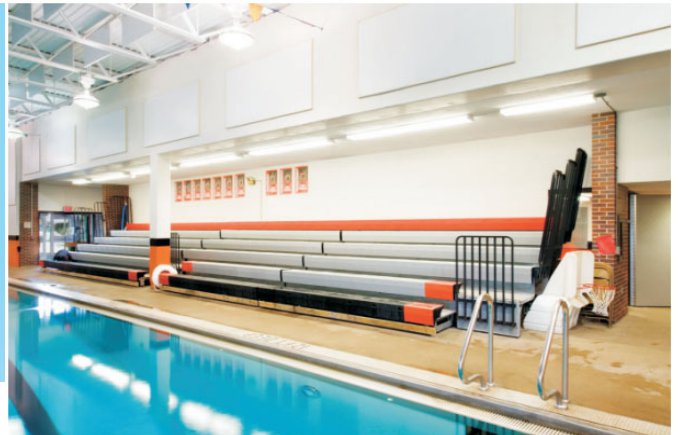

**Application:** Parking garages/stairwells; /docks; /subway station; canopy; walk-in refrigerators; awning; outdoor application...

### ACCESSORIES

**Accessories bag includes:**

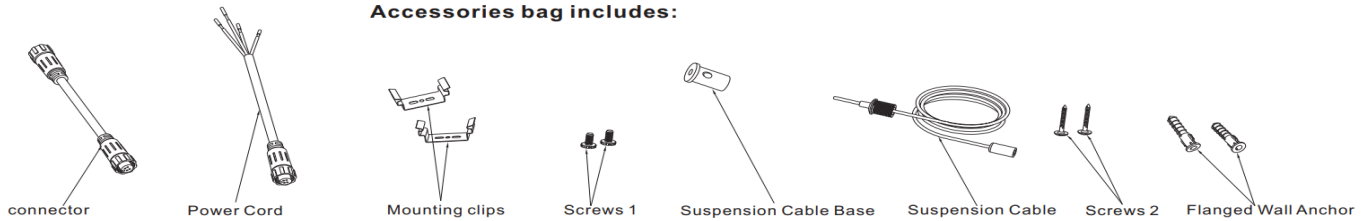

### FEATURE

- 0-10V Dimmable
- Diffusers are extruded from impact modified acrylic for increased durability
- IP 65, waterproof and dustproof
- Suitable for wet location
- Available in 4 foot and 8 foot
- High efficiency: 130lm/w, DLC premium listed
- WARRANTY--5-year limited warranty
- Linkable for Easy Installation: 4FT (Max 4PCS) & 8FT (3PCS)

### SPECIFICATION

	TCL-4FT-LV401-32W-XXK	TCL-8FT-LV401-64W-XXK
Model No.	TCL-4FT-LV401-32W-XXK	TCL-8FT-LV401-64W-XXK
Power:	32W	64W
Size:	4ft	8ft
Lumens	4160 lm	8320 lm
Input Voltage:	100-277VAC	
Dimming:	0-10V Dimmable	
Lumen:	130 LM/W	
Protection Rating:	IP65	
Power Factor:	0.95	
Beam Angle:	110°	
Cri:	>80	
Working Life:	Lumen Maintenance 70% @50,000+ Hours	
Oper. Temperature:	-4°F~+105°F/ -15°C~+40°C	
Certification:	DLC Premium/ ETL	

### ORDERING GUIDE

Company Code	Size	Product	Watt	XXK
TCL	4ft 8ft	LV401: LED TRI-Proof light	4ft: 32W 8ft: 64W	50K: 5000K

## LED TRI-PROOF LIGHT - LV401 Series

### DIMENSION

8ft Front View

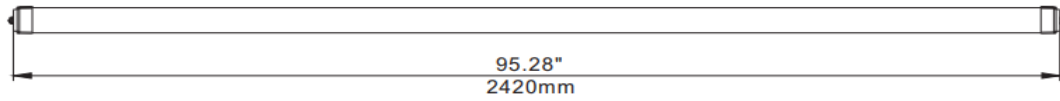

Side View

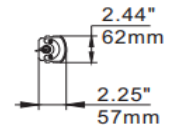

4ft Front View

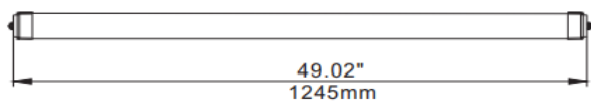

Side View

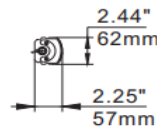

### PACKAGE INFO

Model No.	TCL-4FT-LV401-32W-XXK	TCL-8FT-LV40-64W-XXK
Size	4 ft	8 ft
Qty/Pack	10 PCS	6 PCS
Package Size	1340X370X160mm/52.76"X 14.57"X6.3"	2510X230X160mm/ 98.82"X9.06"X6.3"
Package Weight	7.6 KG/16.8 lbs	14.2 KG/ 31.3 lbs
Package CBM	0.079328	0.092368
40GP Capacity	~7310 PCS	~3760 PCS
40HQ Capacity	~8570 PCS	~4410 PCS
45HQ Capacity	~9830 PCS	~5060 PCS

### PHOTOMETRIC REPORT

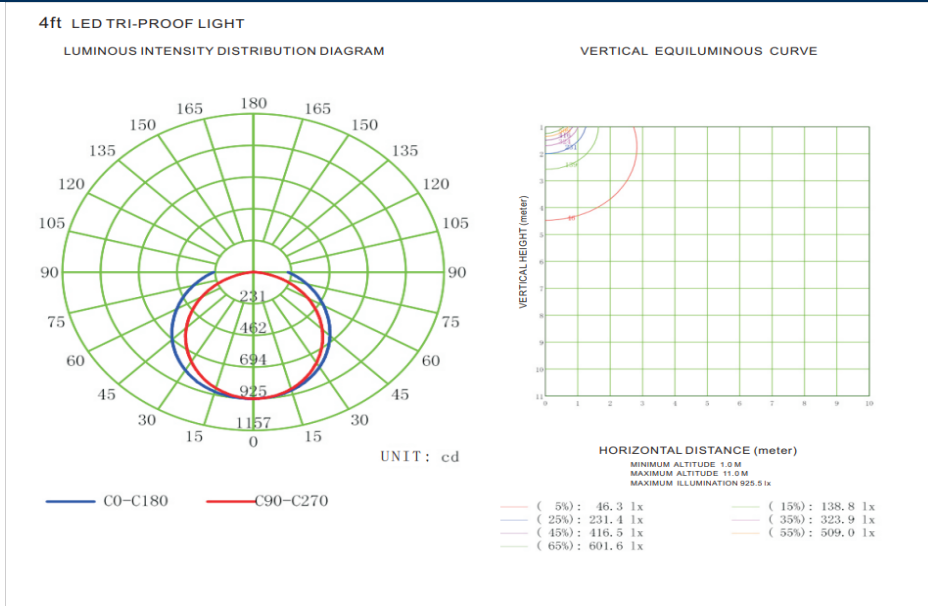

# LED TRI-PROOF LIGHT - LV401 Series

## INSTALLATION

### Surface Mount Installation

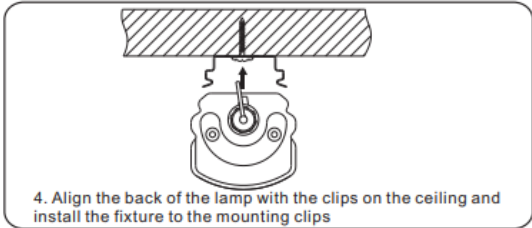
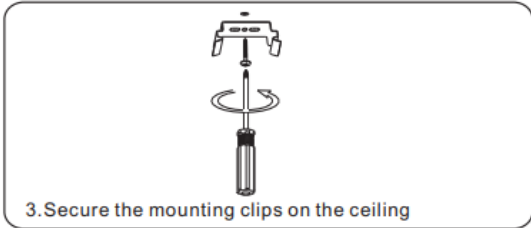
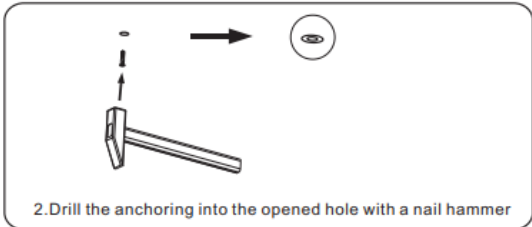
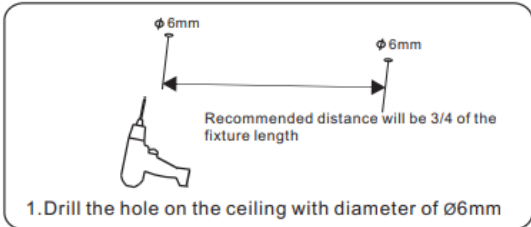

### Suspension Installation

**B Suspension installation**

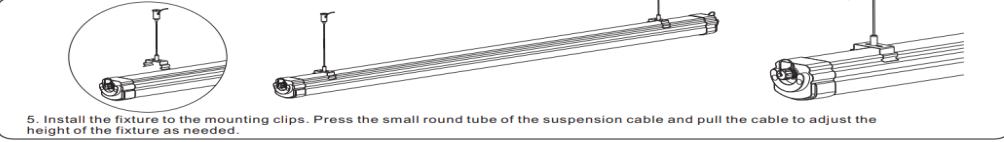
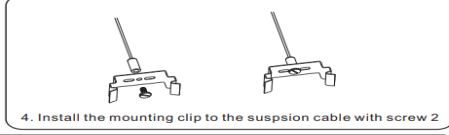
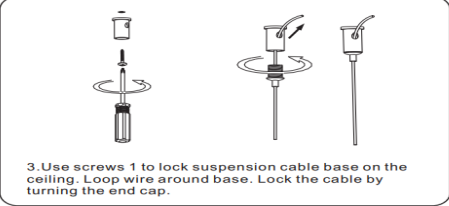
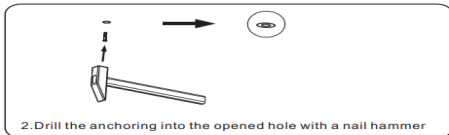
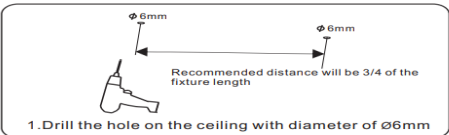

### Connection Installation

**1 Wiring Guide**

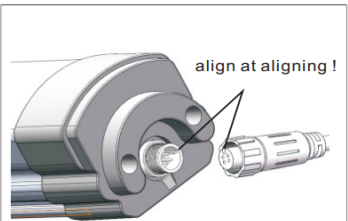
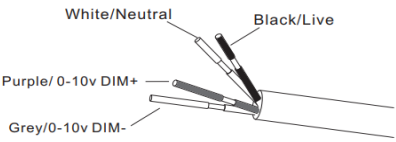

**2 Connection Installation**

1. Please find the connector in the accessories bag.
2. Plug the connector into the tube.

**Note:**  
 For safety standard, please do not connect more than 4pcs 4ft LED lamp in a row; do not connect more than 3 pcs 8ft LED lamp in a row.

